

Liberator® extractorVAC® Safety & Maintenance Instructions

Save these instructions.
Read all instructions before using this machine.

Liberator®

Safety Instructions

When using electrical equipment, basic precautions should always be followed, including the following:

Warning—to reduce the risk of fire, electric shock, or injury:

1. Do not leave machine when plugged in. Unplug from outlet when not in use and before servicing.
2. Do not use outdoors or on wet surfaces.
3. Do not allow to be used as a toy. Close attention is necessary when used by or near children.
4. Use only as described in manufacturer's Instruction Manual. Use only manufacturer's recommended attachments.
5. Inspect cord for damage before each use. Do not use with damaged cord or plug. If machine is not working as it should, has been dropped, damaged, left outdoors, or dropped into water, return it to the manufacturer or authorized repair center.
6. Do not pull or carry by cord, use cord as a handle, close a door on cord, or pull cord around sharp edges or corners. Do not run machine over cord. Keep cord away from heated surfaces.
7. Do not unplug by pulling on cord. To unplug, grasp the plug not the cord.
8. Do not handle plug or machine with wet hands.
9. Do not put any object into openings. Do not use with any opening blocked; keep free of dust, lint, hair, and anything that may reduce air flow.
10. Keep hair, loose clothing, fingers, and all parts of body away from openings and moving parts.
11. Turn off all controls before unplugging.
12. Do not use the Liberator to clean stairs.
13. Do not use to pick up flammable or combustible liquids such as gasoline or use in areas where they may be present.
14. Do not use to pick up anything that is burning or smoking, such as cigarettes, matches, or hot ashes.
15. Do not use to pick up health-endangering dust such as asbestos.
16. Do not use as a wet vacuum.
17. Do not use without filters in place.
18. Connect to a properly grounded outlet only. See *Grounding Instructions*.
19. This machine is to be used with HOST® carpet cleaning products only. Use of other cleaning products may damage this machine.



Grounding Instructions

This machine must be grounded. If it should malfunction or break down, grounding provides a path of least resistance for electric current to reduce the risk of electric shock. This machine is equipped with a cord having an equipment-grounding conductor and grounding plug. The plug must be inserted into an appropriate outlet that is properly installed and grounded in accordance with all local codes and ordinances.

WARNING: Improper connection of the equipment-grounding conductor can result in the risk of electric shock. Check with a qualified electrician or service person if you are in doubt as to whether the outlet is properly grounded. Do not modify the plug provided with the machine. If it will not fit the outlet, have a proper outlet installed by a qualified electrician.

This machine is for use on a nominal 120 volt circuit, and has a grounded plug that looks like the plug illustrated in **Diagram A**. A temporary adapter that looks like the adapter illustrated in **Diagram B** may be used to connect this plug to a 2-pole receptacle as shown in **Diagram C** if a properly grounded outlet

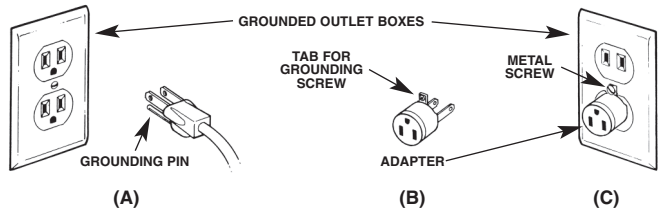

is not available. The temporary adapter should be used only until a properly grounded outlet can be installed by a qualified electrician. The green colored rigid ear, lug, or the like extending from the adapter as illustrated in **Diagram B**, must be connected to a permanent ground outlet box cover. Whenever the adapter is used, it must be held in place by a metal screw as shown in **Diagram C**.

Note: In Canada, the use of a temporary adapter is not permitted by the Canadian Electrical Code.

Machine Maintenance

Follow these guidelines for routine maintenance on your Liberator to obtain optimal performance of both the HOST equipment and cleaning system.

Breaking in New Brushes

Standard (white) and firm (zebra) brushes need to be broken in before using for the first time.

1. Remove the Liberator from the caddy.
2. Place the Liberator on a **smooth concrete surface** and run for 15 minutes.



Machine Maintenance, cont'd.

Emptying the Bagless Hopper

The Liberator has a hopper, rather than a bag, for fast, easy dumping. Check the bagless hopper and empty as needed to prevent overloading. Always empty the bagless hopper before storing the Liberator.

Overloading of the hopper will cause rapid filter clogging as well as HOST Dry Carpet Cleaner to accumulate on the inner cone assembly. See *Cleaning the Interior of the Liberator, #3.*

1. Place one hand on the front of the Liberator above the bagless hopper and pull out the hopper with the other hand. Empty the bagless hopper.
2. After emptying, push the hopper firmly back into the hopper guides until it stops. The hopper must be completely closed (sealed) to maintain full vacuum power and to prevent premature filter clogging.

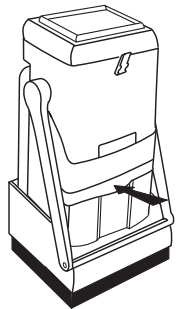

Push hopper firmly into hopper guides to insure a snug seal.

Each time you dump the hopper, it's a good idea to check the filters. You must clean the filters when the light comes on.

Note: When cleaning with HOST SJ, the filter light will come on more frequently and you will have to clean the filters more often.

Cleaning Primary & Secondary Filters When the Filter Light Comes On

1. Turn the Liberator off.
2. Unlatch the filter housing.
3. Lift the filter housing lid up and swing it to one side. (If needed, lift it all the way off.)
4. The Liberator filters are designed to capture fine dust particles. If you are cleaning in healthcare environments or other areas where IAQ is a concern, do not remove and clean the filters in the room being cleaned. Take the Liberator out of the room and clean the filters. You may even want to clean the filters outside of the building. For best results, use a tank vacuum to clean the filters.

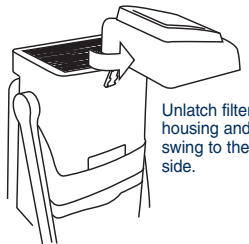

Unlatch filter housing and swing to the side.



Note: You may want to have several extra filters on board the Liberator so you do not have to leave the area to clean the filters. Just replace the dirty filters with clean filters and continue cleaning. Then you can clean the dirty filters later.

5. Replace the filters. **The filters are designed so they can only be replaced in the correct order.** The lower primary filter is burnt orange. The upper secondary filter is black.
6. Lift the filter housing lid and swing it back into place. Be sure it is centered properly and that all the filters are lined up in the correct order. Fasten the latches.

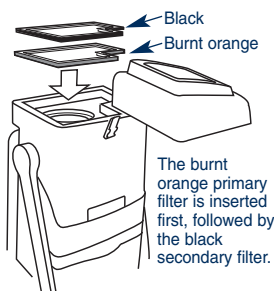

The burnt orange primary filter is inserted first, followed by the black secondary filter.

If after cleaning the filters, the filter light continues to come on, see *Using/Cleaning the 3-Piece Fine Particle Filter or HEPA-type Filters and Loss of Suction Power.*

Using/Cleaning the 3-Piece Fine Particle Filter or HEPA-type Filter

You cannot use these filters together. Use either the 3-piece Fine Particle filter OR the HEPA-type filter. To check these filters, unlatch and take the filter housing lid completely off and turn it over.

3-Piece Fine Particle Filter

The 3-piece filter should be cleaned frequently; daily under high use conditions, weekly if used less. For best results, vacuum filters with a tank vacuum at the end of each day.

1. Remove the foam and felt filters and screen from the filter housing lid. Inspect the filters for soil. If they are soiled, vacuum both sides of each filter.
2. Replace the filters in this order: screen, felt filter, foam filter. The foam filter has a snug fit and will hold the felt filter and screen in place.



HEPA-type Filter

HEPA-type filters are not cleanable and must be replaced when dirty. The HEPA-type filter should be replaced frequently in high use conditions. Here's a quick and easy way to check the HEPA-type filter.

1. Pull on the small tab to remove the filter.
2. Hold filter up to a strong light. If you can see light through the filter, it's still usable. If not, replace with a new HEPA-type filter (available from your HOST Distributor).
3. Insert the filter in the lid, with tab facing you, and replace the filter housing lid. Be sure it is centered properly and that all the filters are lined up. Fasten the latches.

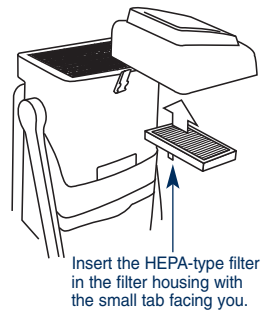

Insert the HEPA-type filter in the filter housing with the small tab facing you.

Note: To avoid damage to the HEPA-type filter, always empty the bagless hopper before storing the Liberator.

Replacing Belts

1. Disconnect Liberator from power.
2. Remove the Velcro skirt.
3. Remove the gear case cover by removing 6 screws.
4. Remove the 2 screws on the large pulley and lift off flange.
5. Cut damaged belt with scissors and remove it.
6. Put new belt onto small pulley first and work it onto the large pulley by turning the cleaning brushes by hand.
7. Replace pulley flange, screws, gear case cover and Velcro skirt.

Large pulley flange & screws for flange

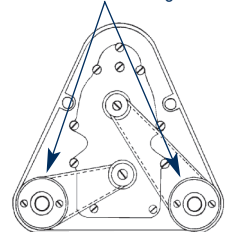

Machine Maintenance, cont'd.

Cleaning the Motor Vents & Filter

It's important that the motor vents and filter on the lower back of the Liberator are kept free of any buildup. **Failure to keep the filter clean could cause the Liberator to overheat.**

Vacuum the motor vents with the Liberator hose **after each use**. Remove and clean the motor filter frequently.

1. Vacuum the motor vents.
2. Remove the Velcro skirt.
3. Remove the screws from the side cover plates and then the back cover plate.
4. Take the cover plates off the Liberator and remove the foam filter underneath the back cover plate. Vacuum or rinse the filter. **Allow to dry completely before replacing.**
5. Replace the motor filter, cover plates, screws, and Velcro skirt.

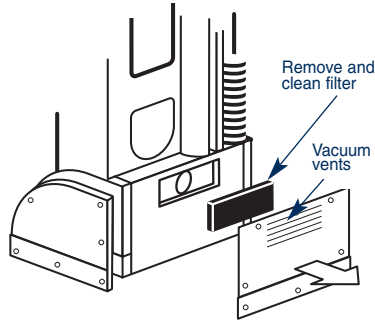

Cleaning & Rotating Brushes

Refer to the separate *HOST System Instruction Manual* to clean and rotate machine brushes.

Cleaning the Interior of the Liberator

Make cleaning the interior of the Liberator part of your daily routine maintenance.

1. Check the vacuum hose for clogs.
 - a. Unplug both ends of the vacuum hose and check for any buildup of HOST or dirt.
 - b. If buildup exists, plug straight end of the vacuum hose into the vacuum connection.
 - c. Turn the vacuum motor on and loosen buildup from the vacuum hose elbow.



2. Check the vacuum shoe between the cleaning brushes on the underside of the Liberator for buildup. Remove any material clogging the shoe. Wipe out the underside of the Liberator with a cloth or brush, or use a vacuum.



Vacuum shoe

3. Check under the separator assembly and in the vacuum cone for buildup. Buildup will occur more frequently if you have not emptied the bagless hopper as often as needed.

- a. With bagless hopper in place, unlatch the top of the machine, swing the filter housing to the side and remove the filters.

- b. Lift out the separator assembly and wipe the underside of the separator assembly and the inside of the vacuum cone with a clean, dry cloth. If there is a thick accumulation on the cone, use a damp cloth to loosen the soil. The loosened soil will drop into the bagless hopper.



Remove the separator assembly to clean the vacuum cone.

- c. Replace the separator assembly and push down firmly until it seals tightly.

Troubleshooting

Loss of Suction Power

1. Clean and/or replace filters.
2. Adjust the Velcro skirt height. The lower edge of the Velcro skirt should just brush the carpet surface. Starting in the middle of the brush guard/end cover plate, line up the slits on the Velcro skirt with the corners of the Liberator.

Also refer to *Cleaning the Interior of the Liberator*.

If Liberator Does Not Run

1. Disconnect Liberator from power.
2. Make sure that the power cord is properly secured to the pigtail twist lock on the back of the machine.
3. Check the wall plug, Liberator power cord and plug for breaks.
4. Check that you have not blown a fuse.
5. Plug the Liberator in. If it doesn't run, be sure you have turned the motor switches on. If the switches are on and it still doesn't run, it should be returned to the manufacturer or authorized repair center. Contact your HOST Distributor.

The electrical cord on the Liberator has been designed to give the proper power to the motor through both the gauge and length of the cord. Do not use an extension cord. The grounding plug at the end of the cord should NOT be removed.

HOST, Liberator, extractorVAC and PREP are registered trademarks of Racine International, LLC. Racine, Wisconsin USA.

© 2005, 2010
Racine International, LLC.
1405 Sixteenth Street
P.O. Box 1648
Racine, WI 53401 USA

☎ (800) 558-9439
☎ (262) 637-4491
FAX (262) 637-0558
www.hostdry.com

host
The Dry Extraction
Carpet Cleaning System

M50265(B)